

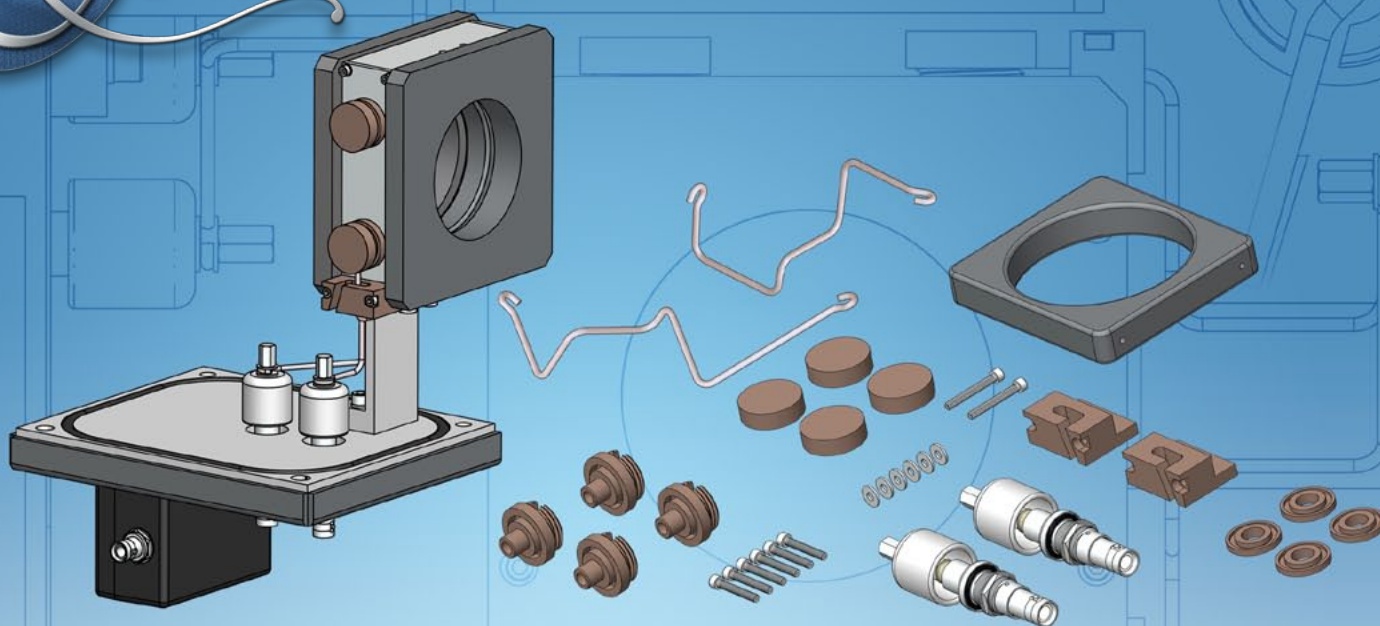

A Resource for Semiconductor Manufacturers



Universal Heavy Process EMER Upgrade Kit - K99398UP2 for **GSD Implanter Systems**

Glemco offers a heavy process upgrade kit for the EMER, that is designed to enhance performance and improve productivity with these advancements...

➤ **Added Isolation**

Redesigned insulating washers features an extended surface area that prolongs coating and eliminates shorting. The insulators completely cover the buss wire connection and come with threaded caps for easier service removal.

➤ **Decreased Particles**

*Industry standard Teflon® coated, Tin plated Copper wire is prone to coating and shorting which causes particles. Glemco has eliminated **Teflon®**, **Tin** and **Copper** from the assembly and uses a robust and reusable solid Tantalum buss wire to deliver up to 5Kv to the inner electrode in the upgrade kit.*

➤ **Leak Shield**

A strong vacuum rated seal is provided by ceramic power feedthroughs. An aluminum shield cup protects Glemco's new feedthrough from process material.

➤ **Optimal Efficiency**

All components are rated for heavy processing at maximum operating parameters of the EMER assembly.



A Resource for Semiconductor Manufacturers

PO Box 217 Leander, TX USA 78646-0217 • 800-621-9598 • sales@glemco.com • www.glemco.com

Glemco® - Any unauthorized use and/or duplication of any material from this brochure without express and written permission from Glemco is strictly prohibited.

K99398UP2 - Universal Heavy Process EMER Upgrade Kit

Glemco's new feedthroughs feature shield cups to protect them from coating and shorting.

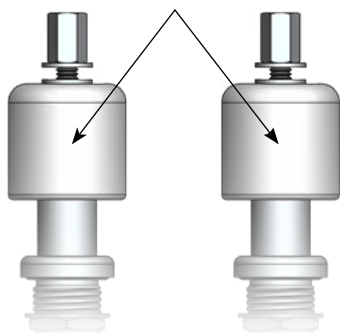

Vacuum rated ceramic to metal power feedthroughs exceed maximum operating parameters of the EMER.

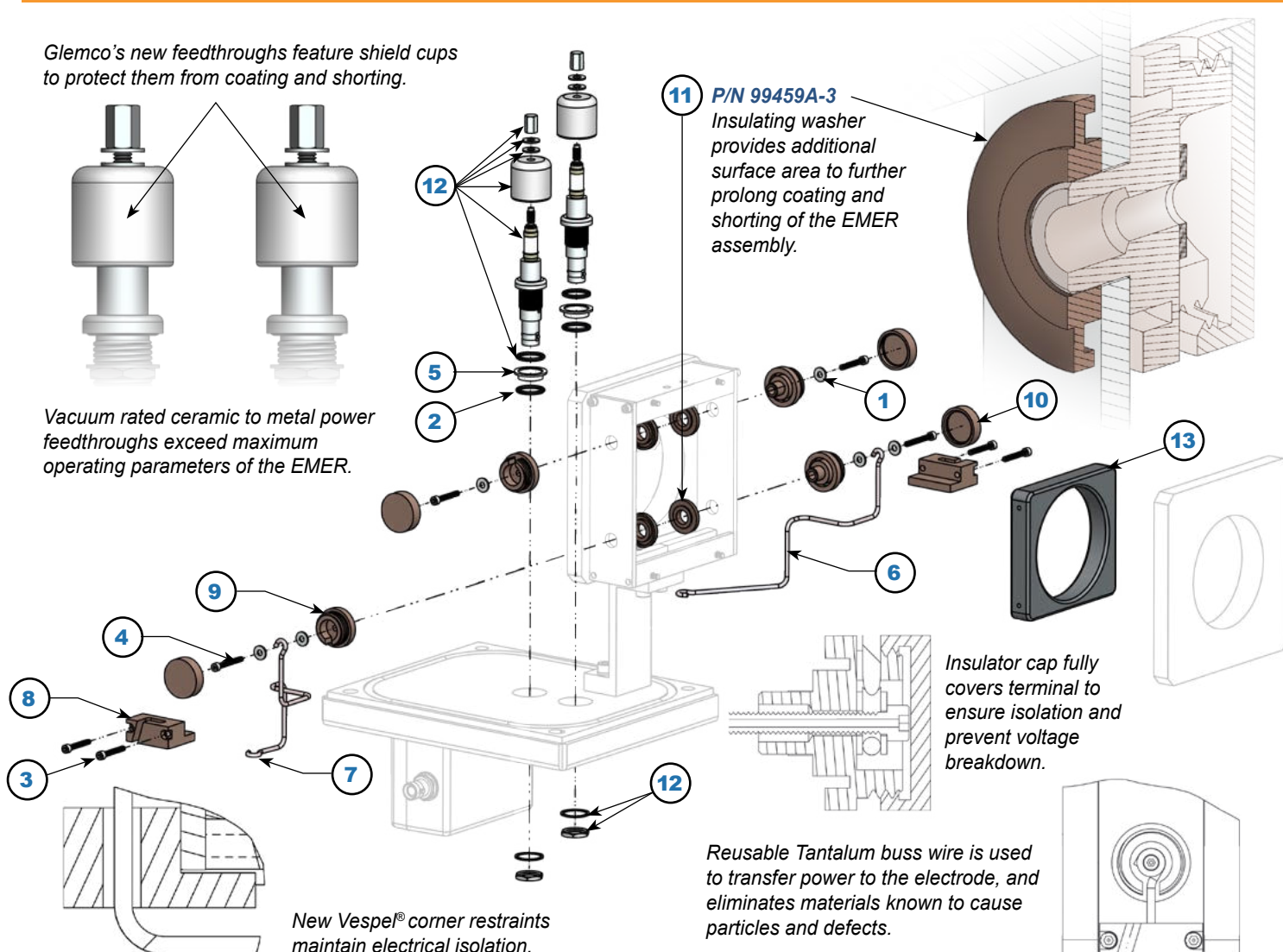

Item	P/N	Description	Qty
1	82456	#4 Narrow Washer, SST	6
2	82914V	- 014, O-Ring, Viton®	2
3	8B287	SHCS, 4-40 X 3/4", Vented, SST	6
4	8B307	SHCS, 4-40 X 7/8", Vented, SST	2
5	99398-6	Insulator Feed-Thru Connector, Delrin®	2
6	99398-12	Feed Wire A, Tantalum	1
7	99398-13	Feed Wire B, Tantalum	1
8	99398-14	Corner Restraint, Vespel®	2
9	99459A-1	Bias Ring Aperture Insulator, Vespel®	4
10	99459A-2	Insulator Cap, Vespel®	4
11	99459A-3	Insulating Washer, Vespel®	4
12	99464B	Feed-Thru Assembly	2
13	99577	Aperture, Graphite	1

Glemco also offers the EMER alignment fixture tool P/N T99398

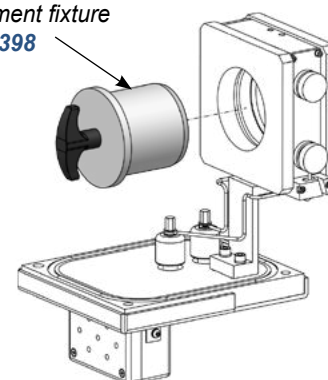

Contact us at sales@glemco.com
Order online at www.glemco.com



A Resource for Semiconductor Manufacturers

PO Box 217 Leander, TX USA 78646-0217 • 800-621-9598 • sales@glemco.com • www.glemco.com

Glemco® - Any unauthorized use and/or duplication of any material from this brochure without express and written permission from Glemco is strictly prohibited.